

Luxor • Lamellgardin

Installationsanvisning för Luxor

Dragstav, Lina, Kedja, Motor

Även för lutande montering

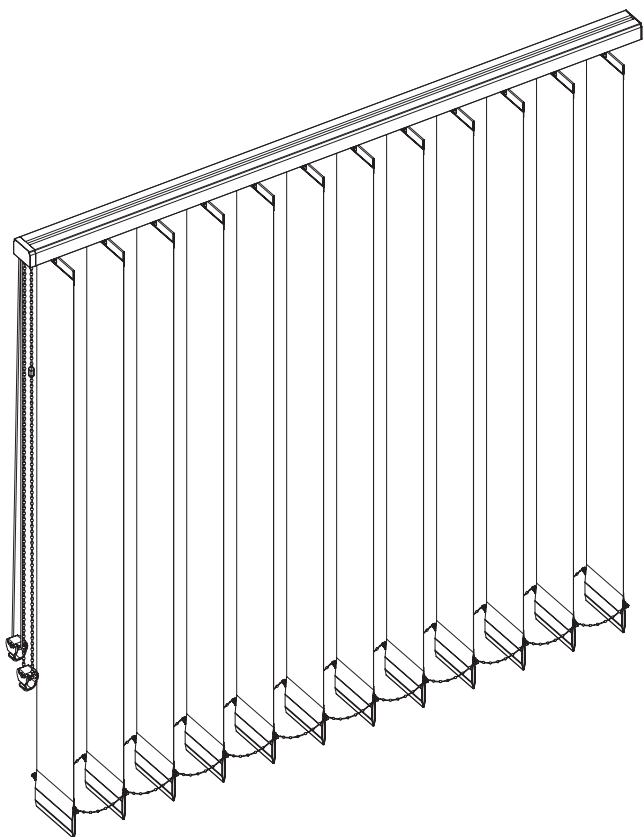

För motordrift, se separat manual

www.nordic-light.com
1-2015

Installation

1

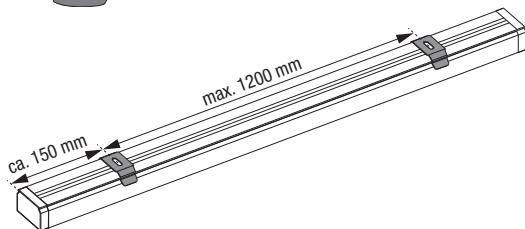
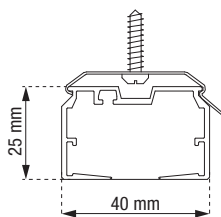
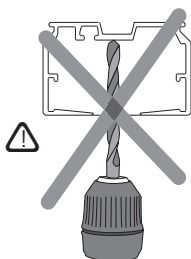
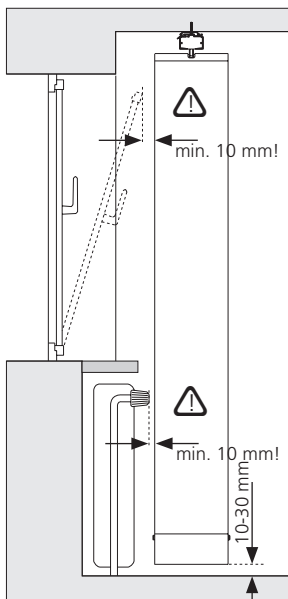

	0 - 1500	1501 - 2700	2701 - 3900	3901 - 5100	5101 - 6300	6301 - 7000
	2	3	4	5	6	7

Installation

1a

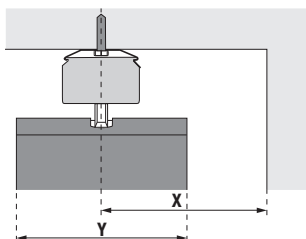

$$X = 1/2 Y + 10$$

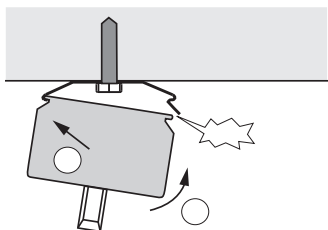

1b

Z =



60 - 108 mm



108 - 156 mm

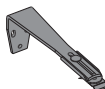

156 - 204 mm

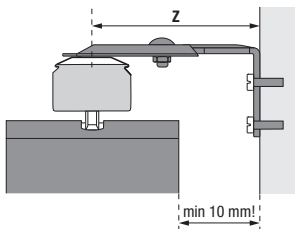

1c

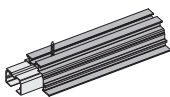

Recess profile
Einbauprofil
Profilé encastrable

Vid lutande installation:
Montera alltid manöversidan i den
höga änden/sidan

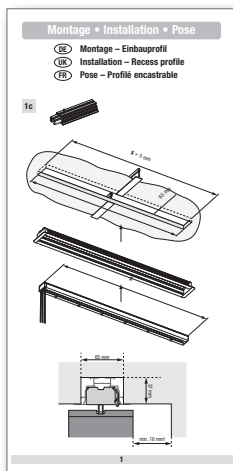

Installation

2

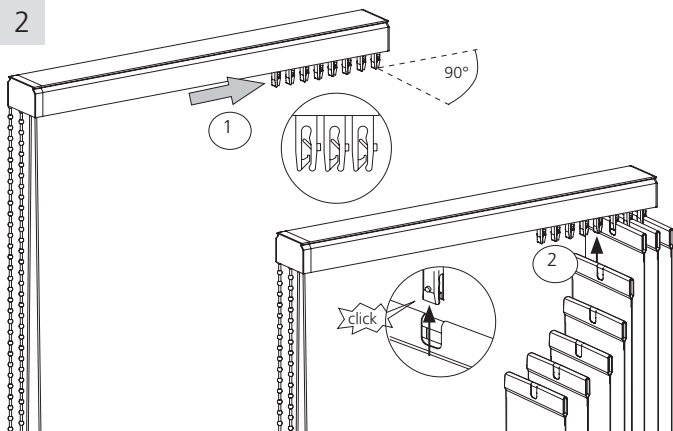

3

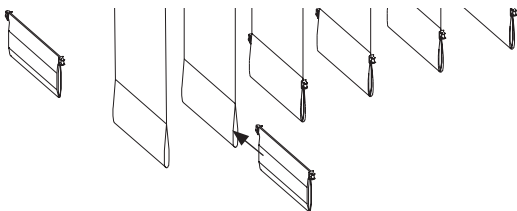

4

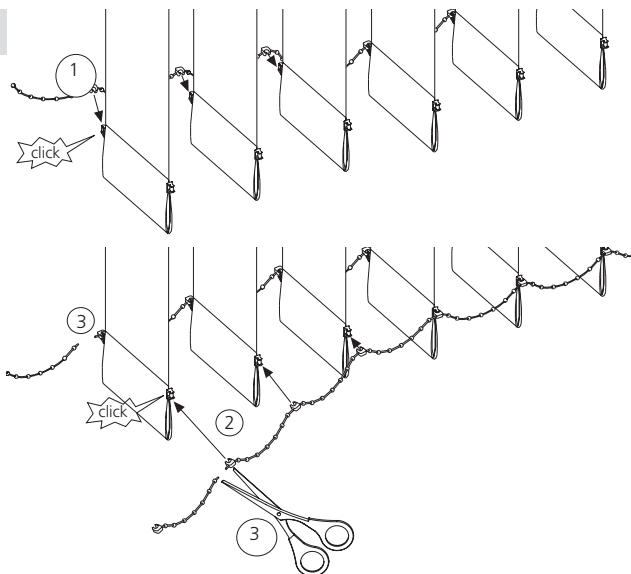

Manövrering

5

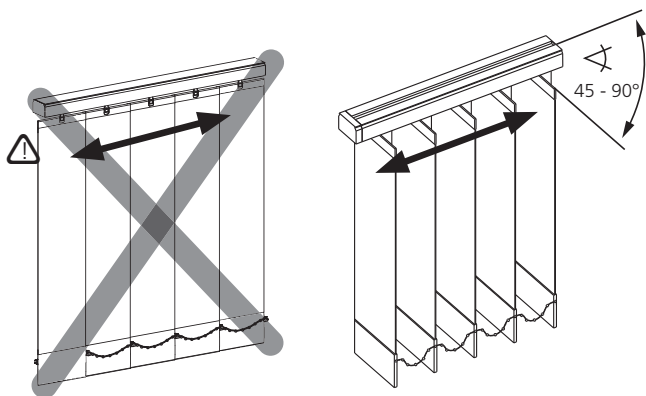

5a

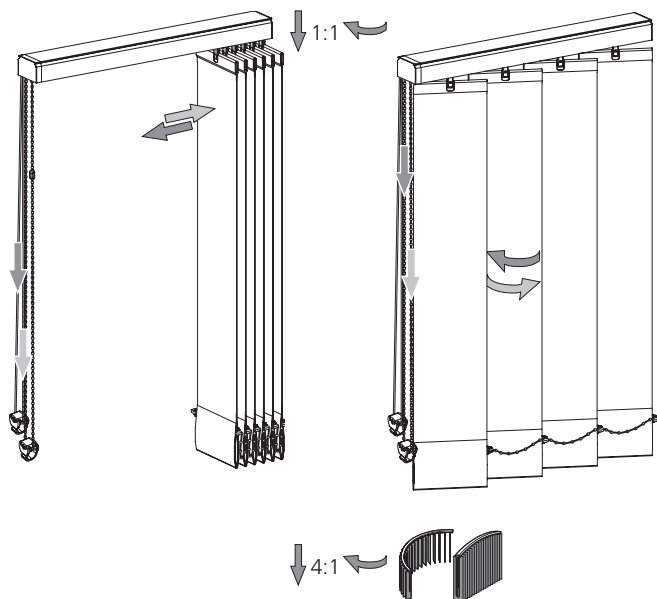
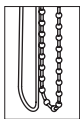

Manövrering

5b

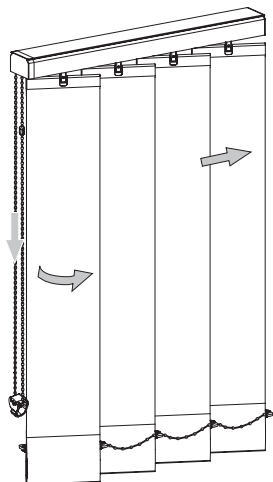
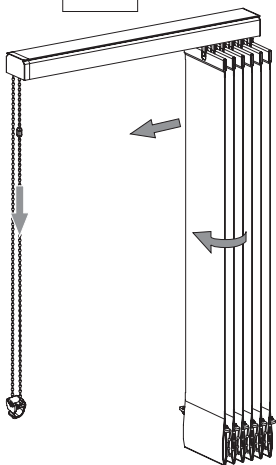
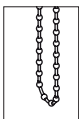

5c

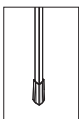

Montera dragstaven:

- 1 Pressa ner öglan i listen för fixering på plats.
- 2: Montera vridstången på öglan
- 3: Lösgör öglan genom att dra i stången uppåt.

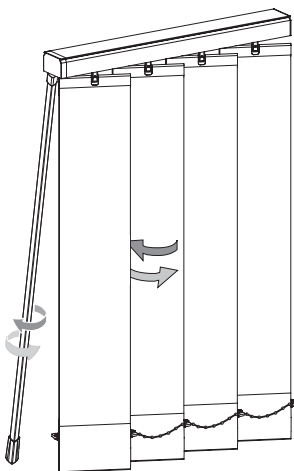
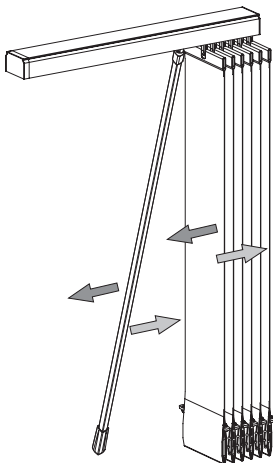
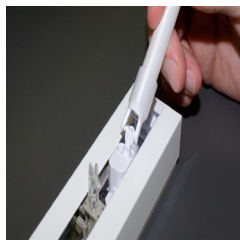

5d

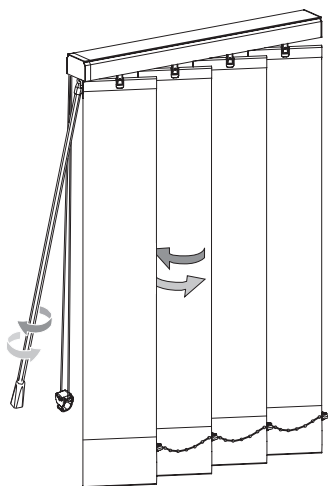
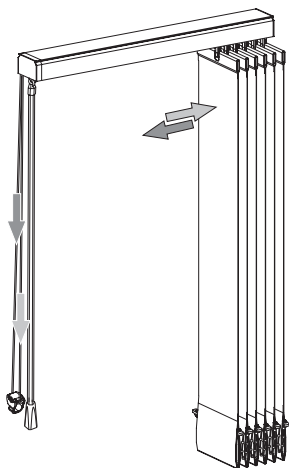
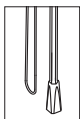

Information

6

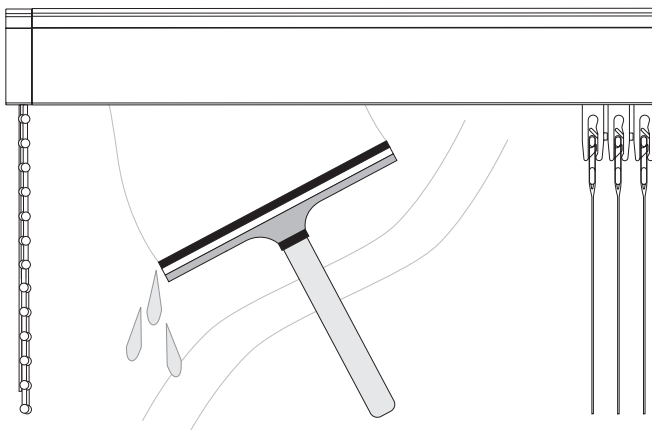
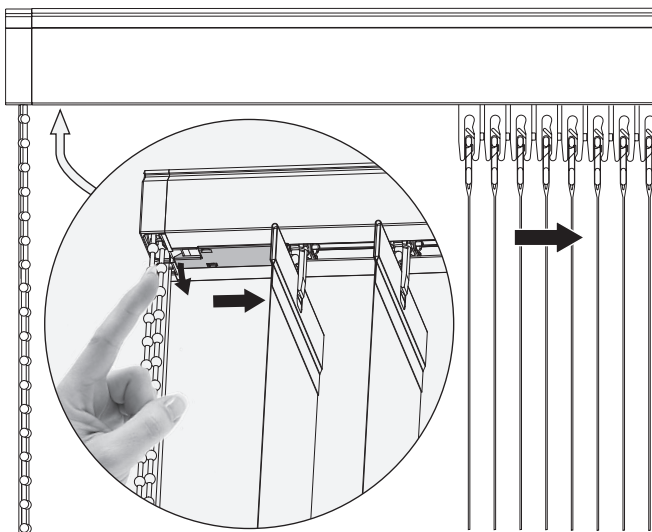

7

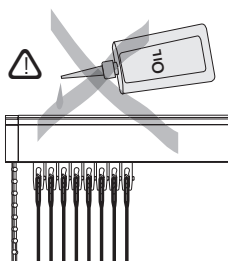

För skötsel och underhåll av dina lameller, vänd dig till din återförsäljare.

Demontering

8

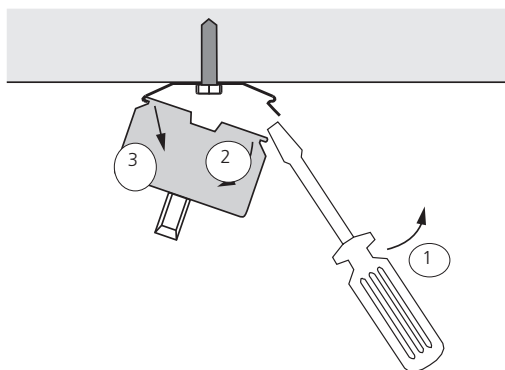
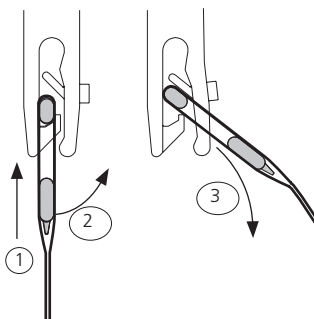
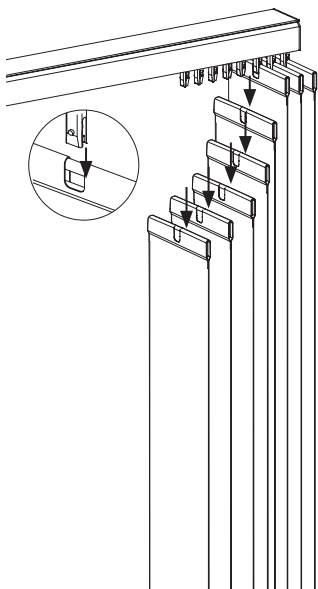
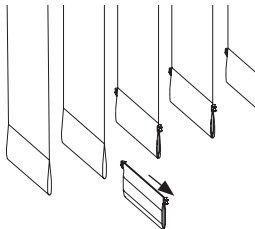
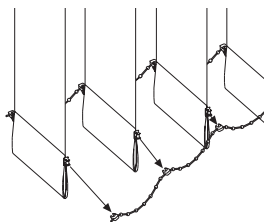

SE

⚠ VARNING ⚠

• Små barn kan strypas av öglor bildade av draglinor, band och inre linor som används för att manövrera produkten.

De kan även råka vira linor runt halsen.

• För att undvika att barn stryps eller trasslar in sig ska linorna hållas utom räckhåll för små barn.

• Flytta sängar, barnsängar och andra möbler bort från solskydens linor.

• Knyt inte ihop linorna.

• Kontrollera att linorna inte trasslar ihop sig och bildar en ögla.

Installera och använd säkerhetsanordningar enligt installationsanvisningarna på produkterna för att minska olycksrisken.



Enligt EN 13120

UK

⚠ WARNING ⚠

• Young children can strangle in the loop of pull cords, tapes and cords that operate window coverings.

They can also wrap cords around their necks.

• To avoid strangulation and entanglement, keep cords out of reach of young children.

• Move beds, cots and furniture away from window covering cords.

• Do not tie cords together.

Make sure cords do not twist and create a loop.

• Install and use the included safety devices according to the installation

instructions on these device to reduce possibility of such an accident.

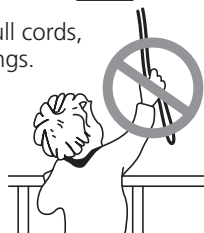

According to EN 13120

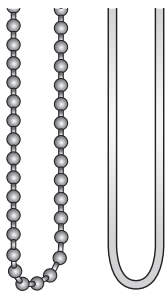

A

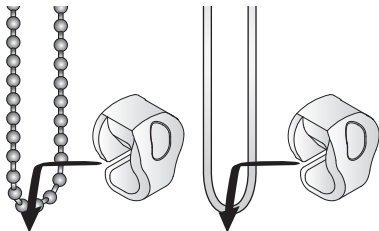

B

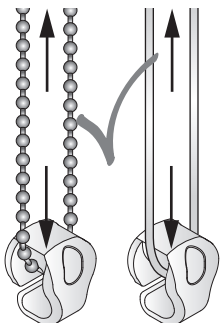
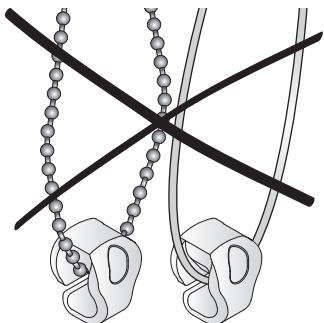

C

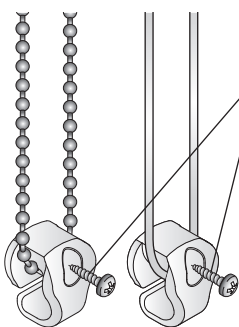

DIN 7981



min. 1,50 m